



R1366

1U black MicroATX server chassis

- ① I/O front or rear-access without extra bracket
- ① aluminum extrusion front bezel with invisible vents
- ① aluminum extrusion front / rear handles
- ① support MicroATX 9.6"x9.6" or 6.7"x6.7" Mini-ITX MB
- ① main construction sheet metal by 1.0mm~1.2mm
- ① all in one fan wire PCB to keep clean cable routing
- ① build in Adda 40mmx20mm two ball bearing fans
- ① bare noise @ 28dBA (fan noise against room noise)
- ① IPC China branded model global 3 years warranty

- * Totally 4 drive bay: 2 x 3.5" and 2 x 2.5" HDD bay
- * drive bay equipped with anti-vibration function
- * two USB 2.0 ports at front bezel
- * aluminum extrusion front bezel with invisible intake air vent holes
- * both I/O front-access or I/O rear-access compatible
- * four brand new Adda AD0412HB-C50 40mm x 20mm exhaust fans against the CPU location
- * Room noise without fan activated is 41dBA, tested by 10cm distance to the running fan is 69dBA (including room noise)
- * all in one fan wire PCB to keep fast system maintenance
- * MB: MicroATX(9.6"x9.6")-Mini-ITX(6.7"x6.7")
- * support standard 1U FlexATX 300W psu (max. psu depth: 150mm)
- * support 1 slot full high expansion card (max. 170mm~245mm long)
- * standard paint: black
- * IPC China branded server chassis model (with build-in fans) global 3 years warranty
- * chassis dimension: 19" x 1U x 366mm (14.4" deep)
- * package: NW 4.1 KG, GW 5.5 KG, 1.38 CUFT (49x56x14cm, single box packed)
- * Patent and Law attorney agency: China GuanDong Kwo Hui Attorney at Law

Ordering Information:

Ordering Model Number and description: R1366 1U black MicroATX server chassis

Optional part number and description 1: (FLEX0130B) 1U FlexATX 300W power supply with PFC (psu size 81.5 x 40.5 x 150/mm)

Optional part number and description 2: Various 1U riser card (depend on specific MB, please inform MB model # to select & match)

Optional part number and description 3: Various 1U active CPU cooler (depend on specific MB, please inform MB model # to match)

Optional part number and description 4: Various 1U black I/O shield (depend on specific MB, please inform MB model # to match)

Optional part number and description 5: (NJ-600) 600mm 2-layer 3-travel universal slide rail (part# is 1 pair)

Optional part number and description 5-1: (1234U-RMK) 1234U rear mounting kit (part# is 1 pair)

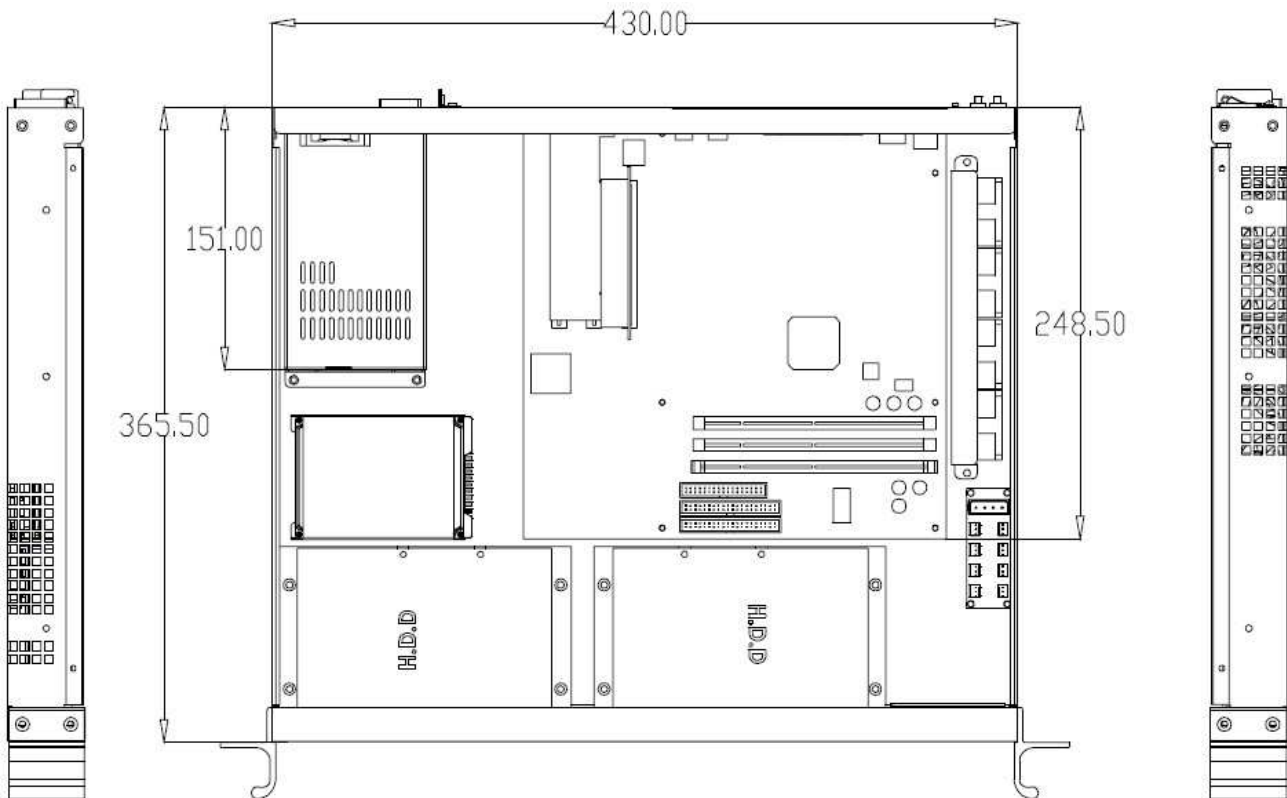

Latest updated on December 21, 2012

IPC China Corporation Copyright reserved©

Without official doc authorized, any commercial behaviors including design & photo are prohibited

中國工控
IPC CHINA
www.chinaipc.cc